

## Packaging Benchmarking Database (Toilet Rolls)

Content Weight	Weight (grams)			% Difference	
	Lightest	Median	Heaviest	Median vs. Lightest	Heaviest vs. Lightest
<b>10 Rolls</b>					
Overall	79.7	95.3	151.8	17.9	62.3
Plastic Wrap (Outer)	21.7	23.5	17.8		
Core	5.8	7.0	13.4		
Plastic Wrap (Inner)	-	-	-		
Plastic Sheet	-	-	-		

(Information correct as of January 2020)

Overall weight may differ due to rounding.

### Illustration of Components

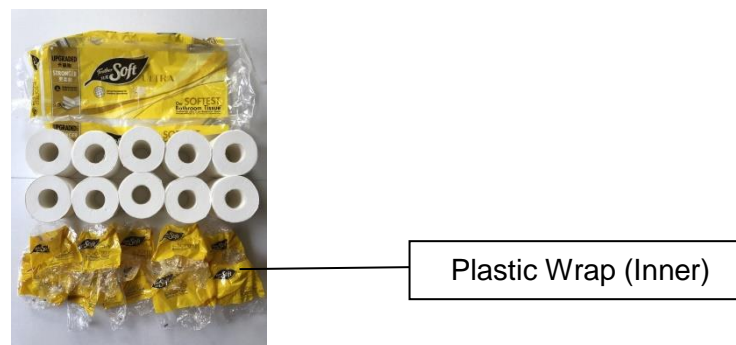
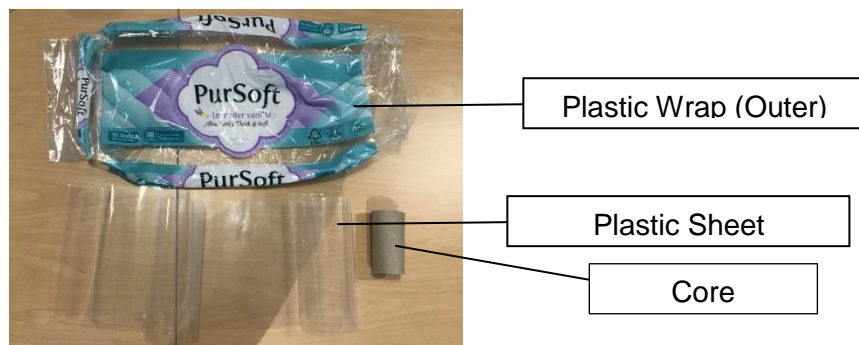

## Packaging Benchmarking Database (Toilet Rolls)

Content Weight	Weight (grams)			% Difference	
	Lightest	Median	Heaviest	Median vs. Lightest	Heaviest vs. Lightest
<b>20 Rolls</b>					
Overall	148.5	167.0	172.0	11.7	14.7
Plastic Wrap (Outer)	34.5	23.0	28.0		
Core	5.7	7.2	7.2		

(Information correct as of March 2020)

*Overall weight may differ due to rounding.*

### Illustration of Components

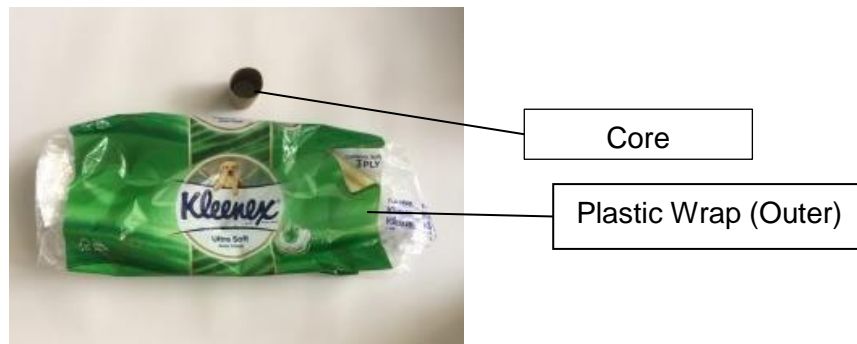

[Terms of Use](#)

## Packaging Benchmarking Database (Toilet Rolls)

Content Weight	Weight (grams)			% Difference	
	Lightest	Median	Heaviest	Median vs. Lightest	Heaviest vs. Lightest
<b>30 Rolls</b>					
Overall	234.4	290.4	330.6	21.8	34.1
Plastic Wrap (Outer)	48.4	47.4	27.3		
Core	6.2	5.8	5.8		
Plastic Wrap (Inner)	-	23.0 (x3)	43.1(x3)		

(Information correct as of March 2020)

Overall weight may differ due to rounding.

### Illustration of Components

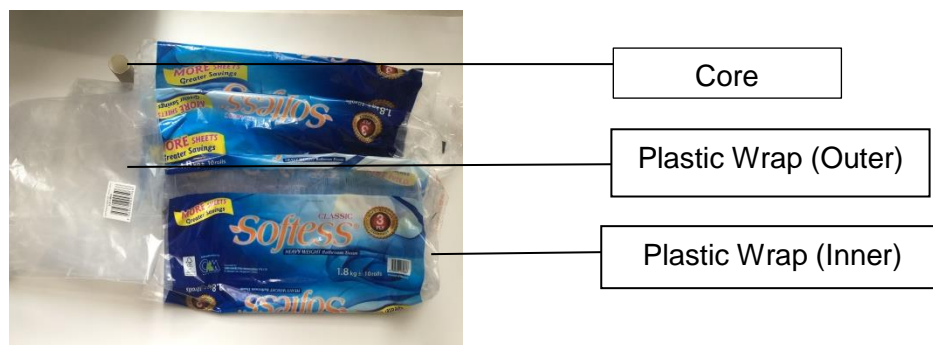

[Terms of Use](#)